

eddissonwhite®



34 christchurch road, colliers wood, SW19 2NX

85 the broadway, wimbledon, SW19 1QE

109 london road, morden, SM4 5HP

W eddissonwhite.co.uk

T 020 8540 9828



## Ashtree Avenue, Mitcham

£575,000 Freehold

3 Bedroom Freehold House - 2 Reception Rooms - EPC 'C'  
Utility Room - Downstairs WC - Contemporary Kitchen/Diner  
Colliers Wood Borders - Private Garden - Stunning Bathroom  
Short Walk To Colliers Wood Tube - Extension Potential (STPP)



company registration no. 05068639 • vat registration no. 843560623



# Ashtree Avenue, Mitcham

## Ground Floor

Approx. 50.8 sq. metres (546.7 sq. feet)

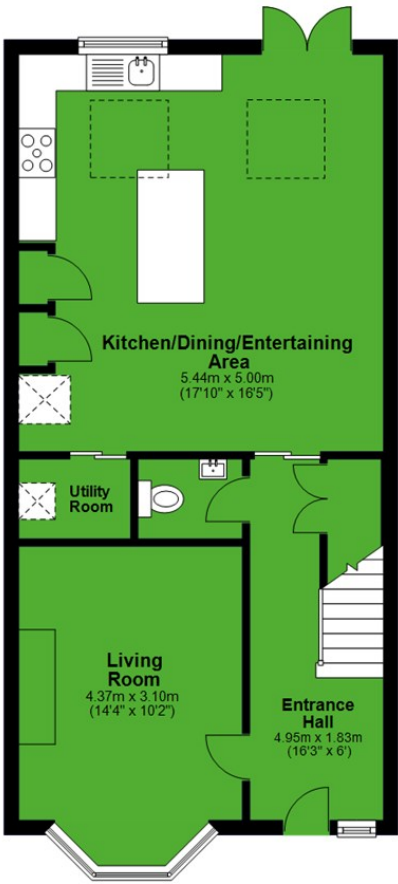

## First Floor

Approx. 38.2 sq. metres (411.5 sq. feet)

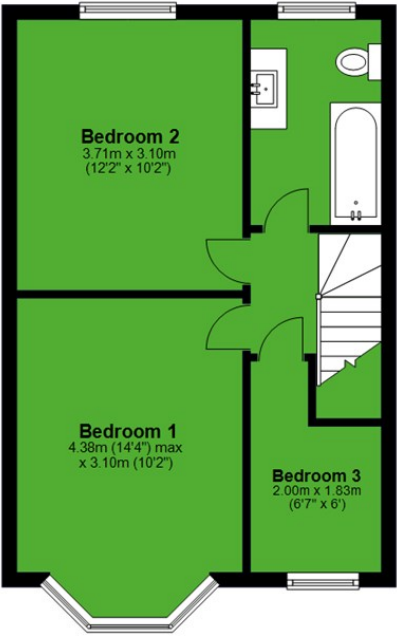

Total area: approx. 89.0 sq. metres (958.2 sq. feet)

Whilst every attempt has been made to ensure the accuracy of the floor plan, measurements of doors, windows and rooms are approximate and no responsibility is taken for any error, omission or misstatement. These plans are for representation only and should be used as such by prospective purchasers. Specifically no guarantee is given on the gross internal floor area of the property if quoted on this plan and any figure given is for guidance only and should not be relied on as a basis of valuation.  
Plan produced using PlanUp.

London Borough of Merton  
Tax Band D  
Freehold

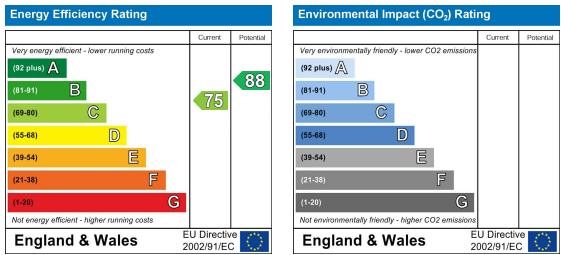

These details and any pictures or plans represent our opinion and are given in good faith for guidance only. They must not be construed as statements or fact. These particulars do not constitute part of an offer or contract. We have not tested the services, appliances or specified fittings and would highly recommend a purchaser to carry out their own survey on the property.